



Mulgrave Road, Sutton, SM2 6LP

£1350 PCM

This immaculate and well-presented two double bedroom ground floor flat is ideally located within walking distance to all the amenities of both Cheam Village and Sutton Town Centre, including shops, restaurants, gyms and open spaces. Both Cheam and Sutton main line railway stations are close by and offer frequent links into Central London. EPC rating C

Convenient location · Well presented ·
Ground floor · Two double bedrooms

Accommodation

The apartment is entered via a hallway with storage cupboards, leading to the spacious lounge/diner with views over the communal gardens, the two double bedrooms, modern fitted kitchen and recently fitted bathroom.

Outside

Attractive communal gardens





Council Tax - C
Tenure - Leasehold

54-56 High Street
Cheam Village
Surrey
SM3 8RW

0208 642 4249
admin@cromwellscheam.co.uk

Disclaimer

These particulars are not an offer or contract, nor part of one. You should not rely on statements made by Cromwells in the particulars or by word of mouth or in writing ("information") as being factually accurate about the property, its condition or value. Neither Cromwells nor any joint agent has authority to make representations about the property, and accordingly any information given is entirely without responsibility on the part of the agents, seller(s) or lessor(s). Photographs show only certain parts of the property as they appeared at the time they were taken. Areas, measurements and distances are given as an approximate only. Any reference to alterations to or use of, any part of the property does not mean that any necessary planning, building regulations or other consents have been obtained

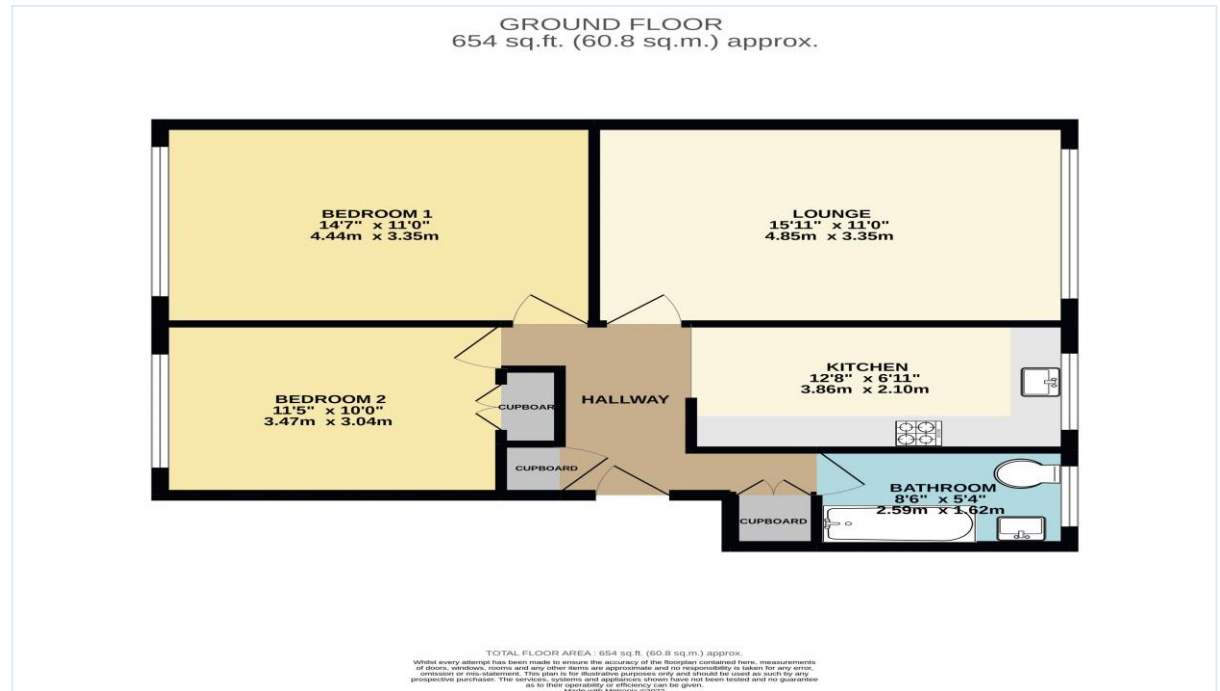

Score	Energy rating	Current	Potential
92+	A		
81-91	B		
69-80	C	69 c	78 c
55-68	D		
39-54	E		
21-38	F		
1-20	G		

Energy efficiency chart

